

质量至上 客户至上 信誉至上

QUALITY FIRST CUSTOMER FIRST REPUTATION FIRST



苏州恒玖锦业智能科技有限公司

Suzhou Hengjiu Jinye Intelligent Technology Co., Ltd.



Mr Wei Wen Dai: 0086 132 7046 5969



Mr Wei Wen Dai: 0086 152 5006 9550



Heng jiu jin ye @ 163.com



喷涂机器人应用



喷涂机器人应用（汽车灯饰）



喷涂机器人应用（五金）



喷涂机器人应用（汽车模型）



喷涂机器人应用（电子）



喷涂机器人应用（模具）



电话: (0086) 0512-69219713 传真: (0086) 0512-69219173

Tel: (0086) 0512-69219713 Web: (0086) 0512-69219173

网址: www.Painting equipment.com www.hengjiujinye.diytrade.com

Url: www.Painting equipment.com www.hengjiujinye.diytrade.com

地址: 中国江苏省苏州吴中区郭巷镇九盛路333号

Add: No. 333, Jiusheng Road, Guoxiang town, Wuzhong District, Suzhou, Jiangsu Province, China

20年专注自动化涂装解决方案服务商

20 years focus on automation coating solutions service providers

公司简介

COMPANY PROFILE



苏州恒玖锦业智能科技有限公司是一家专业从事涂装设备研发、设计、制造、销售、及服务于一体的科技智能型企业。公司引入先进的生产技术和生产设备，拥有高效率的激光切割设备，智能数控钣金设备一体化的专用设备和先进的冲压、焊接、金加工设备。产品核心配件进口自美国、日本、韩国、欧洲，从而确保了产品质量的稳定、可靠、先进。

公司建立了完善的ISO9001-2015 质量标准体系，严格按照GB进行标准化设计规划（GB/T14295-2015）。主要产品有：涂装设备，喷漆设备，自动喷涂设备，自动喷漆设备，喷塑生产线，烘干固化设备，烤漆设备，输送设备，流水线，装配生产线，机器人广泛应用，喷涂废气处理设备，喷涂废水处理设备、无尘净化工程设备，适用于各种：塑胶件、五金件、汽车配件、家具、木制品、电子元器件、航空航天、数码产品、新能源、重型工程车辆配件配件的涂装产品研发、规划、设计、生产、安装、销售交钥匙工程总承包商！凭借二十多年的行业经验，我们能够为客户提供专业自动喷涂解决方案和快速的技术支持，站在客户立场，让客户投入少的资金，产生高效益。

我们以诚信、实力和品质获得客户的高度认可，竭诚欢迎各位新老客户前来参观指导！

Suzhou Hengjiu Jinye Intelligent Technology Co., Ltd. is a professional coating equipment r & D, design, manufacturing, sales and service in one of the technology-based

intelligent enterprises. The company introduces advanced production technology and production equipment, with high efficiency of laser cutting equipment, intelligent sheet metal equipment, integration of special equipment and advanced stamping, welding, metal processing equipment. The core parts of our products are imported from America, Japan, Korea and Europe, thus ensuring the stable, reliable and advanced quality of our products. The company has established a sound ISO9001-2015 quality standard system, in strict accordance with GB standard design planning (GB/T14295-2015).

The main products are: painting equipment, painting equipment, automatic spraying equipment, automatic painting equipment, spray production line, drying curing equipment, painting equipment, transportation equipment, assembly line, robot is widely used, spraying waste gas treatment equipment, spraying waste water treatment equipment, dust-free purification engineering equipment, apply to all kinds of: plastic parts, hardware, auto parts, furniture, wood products, electronic components, aerospace, digital products, new energy, heavy engineering vehicle parts coating product development, planning, design, production, installation, sales turn-key EPCM! With more than 20 years of industry experience, we can provide customers with professional automatic spraying solutions and rapid technical support, stand in the position of customers, so that customers invest less money, high efficiency. We integrity, strength and quality of customers highly recognized, sincerely welcome new and old customers to visit the guidance!

公司荣誉

COMPANY HONOR





机器人喷涂 Robot Spray

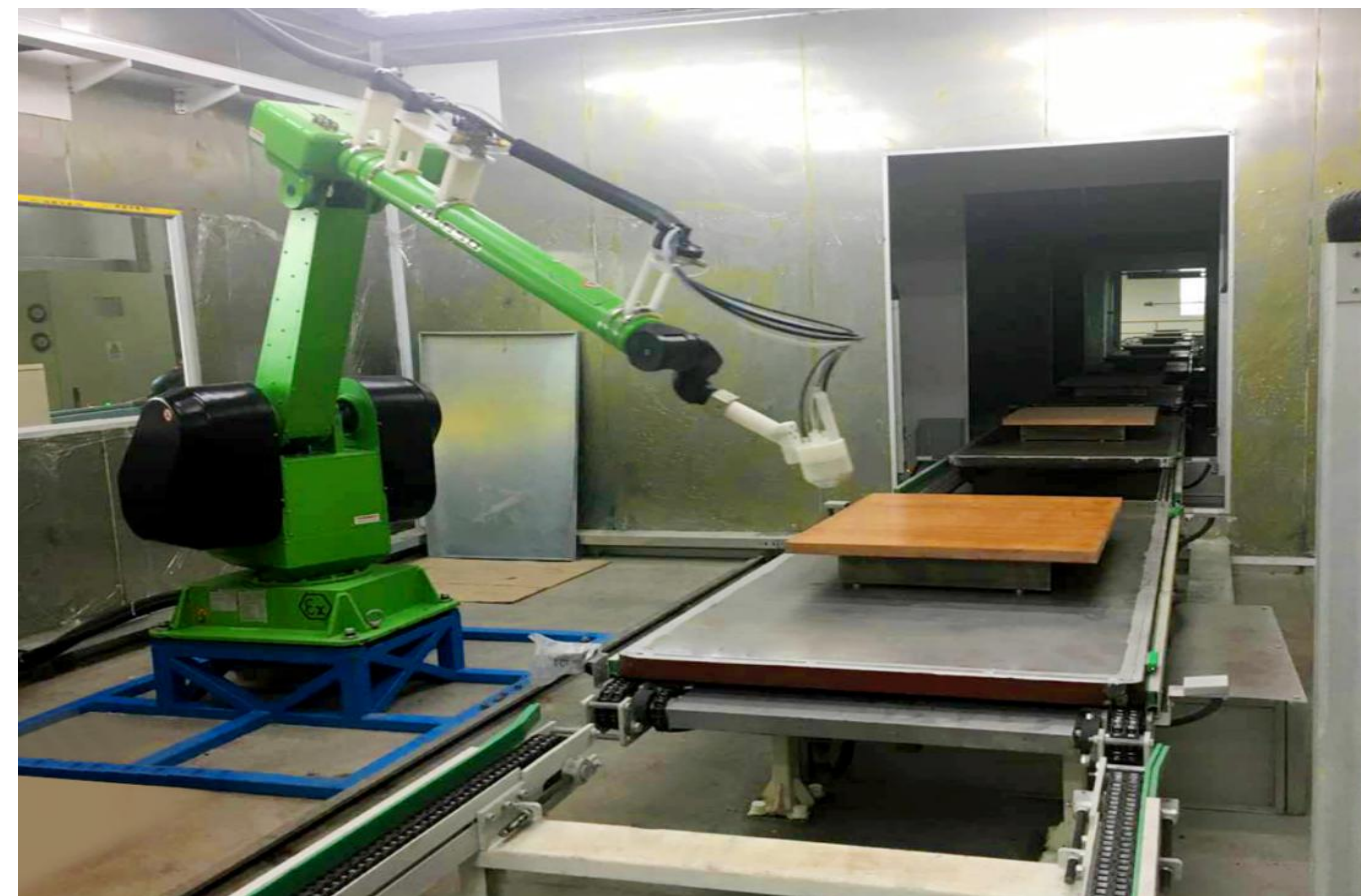

产品特点

- ◆用于喷漆作业：适用五金产品，塑胶产品，玻璃制品，木制品，电子产品，航空航天产品...
- ◆生产线采用50.8地轨品字链条传送，运行平稳，每分钟可达3-10米线速度。机架采用碳钢进行焊接打磨抛光处理，可配机器人或者固定式喷枪进行喷涂。
- ◆喷漆室采用全不锈钢304制作，耐酸耐碱，水泵采用防腐水泵，抽风效果非常稳定，易于清理。
- ◆喷漆室送风采用喷漆室顶部送风。正负压可以调
- ◆烤炉采用120K保温板进行搭建，最高温度可达200°，表面不烫手，可配加热管或者天然气加热方式进行加热
- ◆废气处理设备采用气旋式漩涡水洗-活性炭箱处理在达标排放。可达环保要求。
- ◆使用温度100℃-200℃

Product Features

- ◆ For spray painting: suitable for hardware products, plastic products, glass products, wood products, electronic products, aerospace products...
- ◆ The production line adopts 50.8 earth rail product word chain transmission, running smoothly, every minute can reach 3-10 meters line speed. The frame is welded, polished and polished with carbon steel, and can be sprayed by robot or fixed spray gun.
- ◆ Spray paint room made of all stainless steel 304, acid and alkali resistance, anti-corrosion pump pump, pumping the Phoenix effect is very stable, easy to clean.
- ◆ Spray-paint room air supply using spray-paint room top air supply. Positive and negative pressure can be adjusted
- ◆ Applicable temperature:100-200℃.

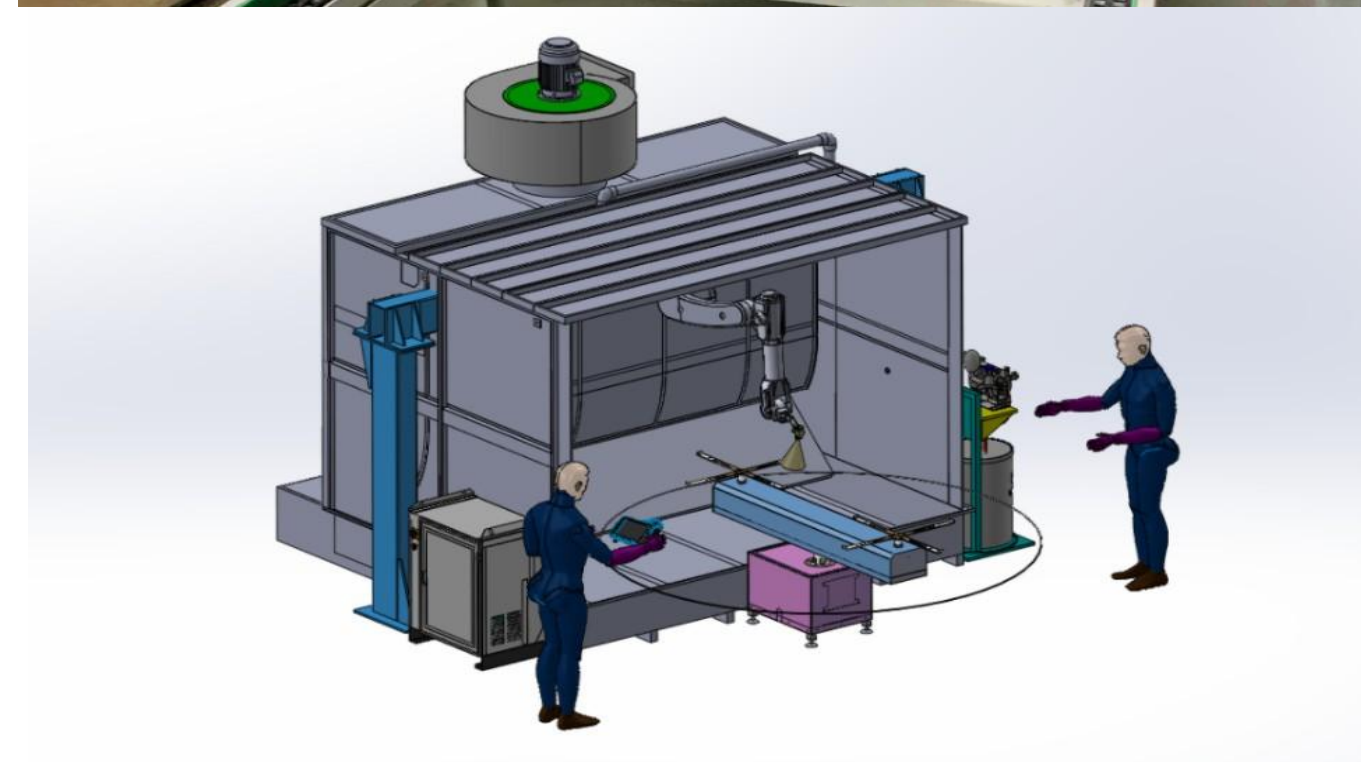

专业设计、制造、涂装设备并提供全面工程及解决方案

Professional design, manufacturing, and coating equipment, providing comprehensive engineering and solutions



自动喷漆线

Automatic paint spraying line



产品特点

- ◆用于喷漆作业：适用五金产品，塑胶产品，玻璃制品，木制品，电子产品，航空航天产品...
- ◆生产线采用50.8地轨品字链条传送，运行平稳，每分钟可达3-10米线速度。机架采用碳钢进行焊接打磨抛光处理，可配机器人或者固定式喷枪进行喷涂。
- ◆喷漆室采用全不锈钢304制作，耐酸耐碱，水泵采用防腐水泵，抽风效果非常稳定，易于清理。
- ◆烤炉采用120K保温板进行搭建，最高温度可达200°，表面不烫手，可配加热管或者天然气加热方式进行加热
- ◆废气处理设备采用气旋式漩涡水洗-活性炭箱处理在达标排放。可达环保要求
- ◆使用温度100-200℃

Product Features

- ◆ For spray painting: suitable for hardware products, plastic products, glass products, wood products, electronic products, aerospace products...
- ◆ The production line adopts 50.8 earth rail product word chain transmission, running smoothly, every minute can reach 3-10 meters line speed. The frame is welded, polished and polished with carbon steel, and can be sprayed by robot or fixed spray gun.
- ◆ Spray paint room made of all stainless steel 304, acid and alkali resistance, anti-corrosion pump pump, pumping the Phoenix effect is very stable, easy to clean.
- ◆ Spray-paint room air supply using spray-paint room top air supply. Positive and negative pressure can be adjusted
- ◆ Applicable temperature:100-200℃.

专业设计、制造、自动喷漆设备并提供全面工程及解决方案

We specialize in designing, manufacturing, and providing comprehensive engineering and solutions for automatic painting lines, as well as automatic painting equipment



五金喷塑生产线

Hardware spraying production line



产品特点

- ◆ 高效生产：能够实现连续化、自动化作业，大大提高了生产效率，缩短了生产周期。
- ◆ 涂层质量稳定：采用标准化的操作流程和参数控制，确保了涂层的厚度均匀、色泽一致，提高了产品的外观质量和防护性能。
- ◆ 节约材料：精确的喷涂控制可以减少涂料的浪费，提高涂料的利用率，降低生产成本。
- ◆ 适应性强：可以适应不同形状、尺寸和材质的工件，具有广泛的应用范围。
- ◆ 环保性能好：相较于传统涂装方式，喷塑过程中产生的挥发性有机化合物（VOCs）排放较少，对环境的污染相对较小。
- ◆ 操作简便：自动化程度高，操作人员经过简单培训即可上手操作，降低了对人工技能的依赖。
- ◆ 维护方便：设备结构相对较为简单，易于日常维护和保养，保证了生产线的稳定运行。
- ◆ 提升产品附加值：优质的喷塑涂层可以增强产品的耐腐蚀性、耐磨性和装饰性，从而提升产品的附加值和市场竞争力。

Product Features

- ◆ Efficient production: can achieve continuous, automatic operation, greatly improve the production efficiency, shorten the production cycle.
- ◆ Stable coating quality: adopting standardized operation process and parameter control to ensure uniform coating thickness, color consistency, improve product appearance quality and protection performance.
- ◆ Saving Materials: accurate spraying control can reduce the waste of paint, improve the utilization of paint, reduce production costs.
- ◆ Strong Adaptability: can adapt to different shapes, sizes and materials of the workpiece, with a wide range of applications.
- ◆ Good environmental performance: compared with the traditional coating method, the process of plastic spray produced less volatile organic compounds (VOCs) emissions, relatively small environmental pollution.
- ◆ Easy to operate: high degree of automation, the operator after a simple training can start to operate, reduce the dependence on artificial skills.
- ◆ Easy Maintenance: the equipment structure is relatively simple, easy to daily maintenance and maintenance, to ensure the stable operation of the production line.
- ◆ Enhance product added value: high-quality spray coating can enhance the corrosion resistance, wear resistance and decorative products, thus enhancing the value-added products and market competitiveness.



专业设计、制造、销售自动喷塑设备并提供全面工程及解决方案

Professional design, manufacturing, and sales of automatic spray painting equipment, providing comprehensive engineering and solutions



浸漆、浸塑生产线

Immersion paint and immersion plastic production line

产品特点

- ◆良好的防护性能：浸塑涂层能够全方位覆盖工件，提供出色的防锈、防腐防磨损保护，延长工件的使用寿命。
- ◆涂层均匀且厚度可控：通过精确的工艺控制，可以确保涂层厚度均匀一致。
- ◆外观美观：能赋予工件光滑、平整且色彩鲜艳的外观，增强产品的装饰性。
- ◆材料适应性广：适用于各种金属和非金属材料，如钢铁、铝、塑料等。
- ◆高效生产：可实现连续作业，生产效率较高，能够满足大规模生产的要求。
- ◆成本相对较低：相较于一些其他表面处理工艺，浸塑的材料成本和设备投资相对较为经济。
- ◆操作简单：工艺流程相对简洁，操作人员易于掌握和操作。
- ◆环保优势：一些浸塑材料环保性能较好，且生产过程中产生的污染物相对较少。
- ◆涂层附着力强：浸塑涂层与工件表面结合紧密，附着力强，不易脱落。
- ◆具有一定的弹性和耐冲击性：能够在一定程度上缓冲外界的冲击，保护工件。



Product Features

- ◆good protective performance: dip coating can cover all-round workpiece, provide excellent rust-proof, anti-corrosion and anti-wear protection, extend the service life of the workpiece.
- ◆coating uniform and controllable thickness: through accurate process control, you can ensure uniform coating thickness.
- ◆appearance: can give the workpiece smooth, flat and bright color appearance, enhance the decorative products. Wide adaptability of materials: suitable for all kinds of metal and non-metal materials, such as steel, aluminum, plastic and so on.
- ◆efficient production: can achieve continuous operation, high production efficiency, can meet the requirements of large-scale production. Relatively low cost: compared with some other surface treatment process, the material cost and equipment investment is relatively economical.
- ◆simple operation: the process is relatively simple, the operator is easy to grasp and operate. Environmental Protection Advantages: some DIP plastic material environmental protection performance is good, and the production process of relatively few pollutants.
- ◆coating adhesion: dip coating and the surface of the workpiece in close contact, strong adhesion, no  o fall off. 10 has a certain degree of elasticity and impact resistance: can buffer the impact of the outside to a certain extent, to protect the workpiece.

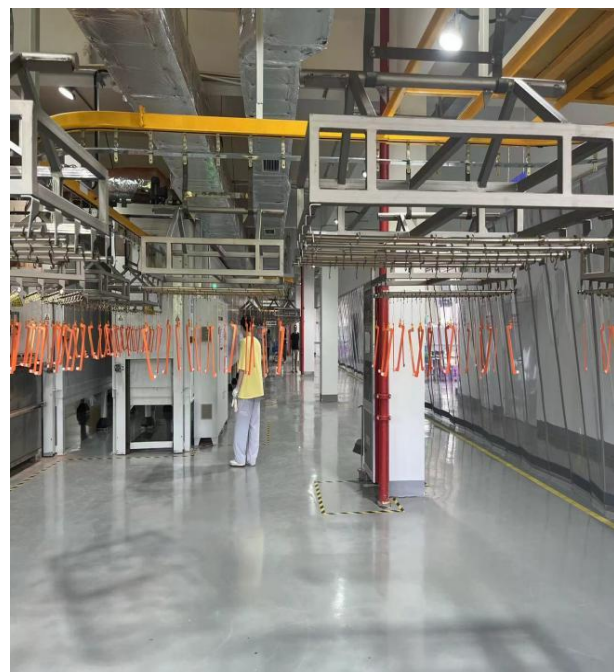

专业设计、制造、销售浸涂、浸漆生产线并提供全面工程及解决方案

We specialize in designing, manufacturing, and selling immersion and coating production lines, and provide comprehensive engineering and solutions



重型工件涂装

Coating of large workpieces



产品特点

- ◆大面积覆盖：由于工件体积和尺寸较大，需要大量的漆料来实现全面均匀的覆盖，以确保防护和美观效果。
- ◆复杂表面处理：重型工件可能具有复杂的形状和结构，这使得喷漆过程中表面处理难度增加，需要更精细的打磨、清洁和预处理，以保证漆层的附着力和质量。
- ◆多层涂装：为了达到良好的防腐、耐磨等性能，往往需要进行多层喷漆，每层之间需要适当的干燥和处理时间，以避免层间缺陷。
- ◆高施工要求：通常需要专业的喷漆设备和技术人员，以确保漆料均匀分布，避免流挂、气泡、橘皮等缺陷。
- ◆环境保护：由于喷漆量较大，会产生较多的挥发性有机化合物（VOCs），因此需要严格的环保措施来控制排放，符合相关法规要求。
- ◆耐久性考量：由于重型工件在使用过程中可能面临恶劣的环境和高强度的使用条件，喷漆的耐久性和防护性能至关重要，需要选择高质量的漆料和合适的喷漆工艺。
- ◆成本较高：包括漆料成本、设备成本、人工成本以及后续的处理和维护成本等，都相对较高。



Product features

- ◆Large coverage: because of the large volume and size of the workpiece, a large amount of paint is needed to achieve a full and uniform coverage to ensure protection and aesthetic effect.
- ◆Complex surface treatment: heavy workpieces may have complex shapes and structures, which make surface treatment more difficult during painting and require more fine grinding, cleaning and pretreatment, to ensure the adhesion and quality of the coating.
- ◆ multi-layer coating: in order to achieve good corrosion resistance, wear resistance and other properties, often need to carry out multi-layer spray, each layer needs appropriate drying and processing time to avoid inter-layer defects.
- ◆ High Construction Requirements: professional painting equipment and technical personnel are usually required to ensure uniform distribution of paint, to avoid sagging, bubble, orange peel and other defects.
- ◆.Environmental Protection: due to the large amount of paint spray, more volatile organic compounds (VOCs) will be produced, so strict environmental protection measures are needed to control emissions, in line with relevant regulations.
- ◆Durability considerations: because heavy-duty workpieces may face harsh environmental conditions and high-strength service conditions during use, the durability and protective properties of spray paint are crucial, need to choose high-quality paint and the appropriate spray paint process.
- ◆high cost: including paint cost, equipment cost, labor cost and follow-up treatment and maintenance costs, are relatively high.

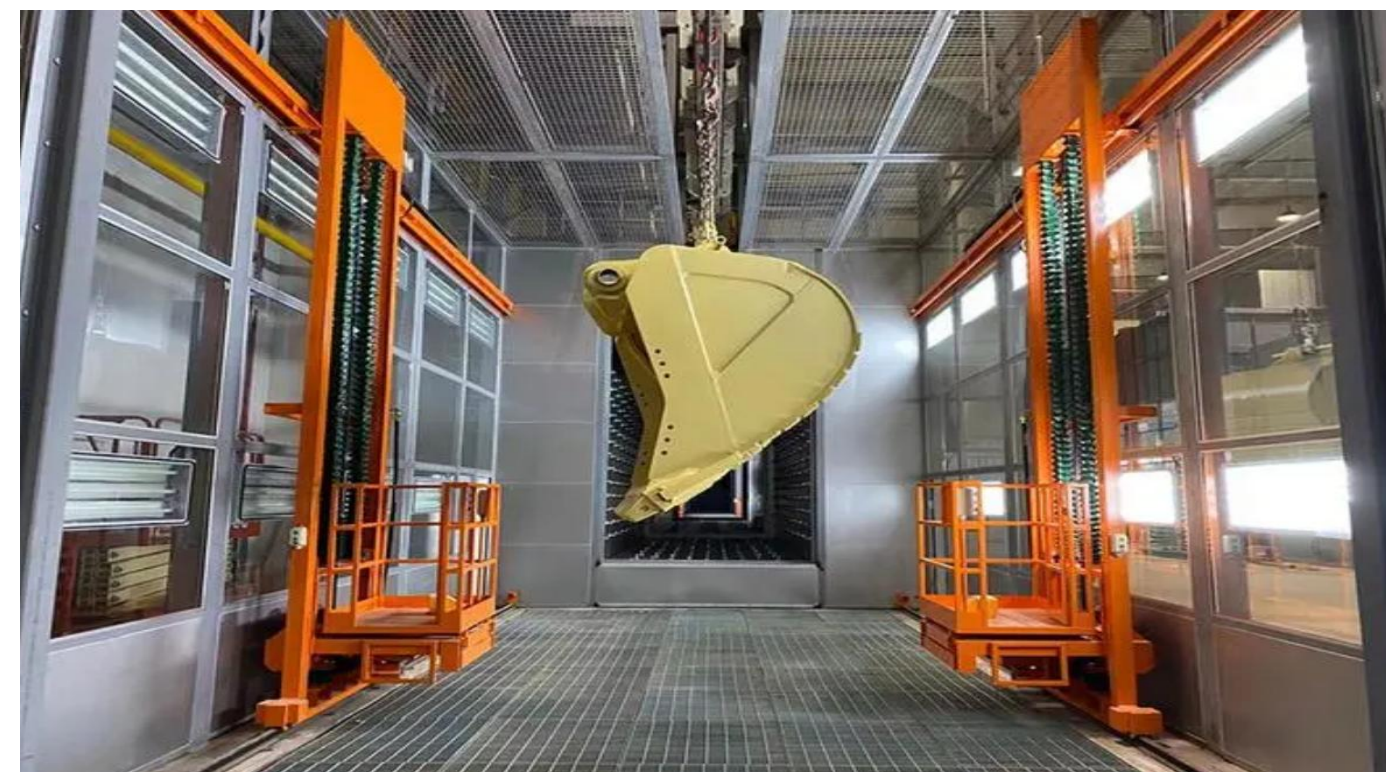

专业设计、制造、销售 大型涂装设备并提供全面工程及解决方案

Professional design, manufacturing, and sales of large-scale painting equipment, providing comprehensive engineering and solutions



输送式烘干固化设备

Conveyor drying and solidification equipment

产品特点

- ◆连续生产：能够实现物料的连续输送和加热，大大提高了生产效率，适合大规模、批量生产。
- ◆温度均匀：通过合理的风道设计和加热元件布局，使炉内温度分布较为均匀，保证产品受热一致，从而提高产品质量的稳定性。
- ◆自动化程度高：可与自动化生产线配套使用，实现进料、加热、出料等环节的自动控制，减少人工干预，降低劳动强度。
- ◆加热方式多样：常见的有电加热、燃气加热、燃油加热等，可根据实际需求和能源供应情况选择合适的加热方式。
- ◆节能高效：良好的保温性能能够有效减少热量散失，提高能源利用率，降低生产成本。
- ◆适应性强：可适用于多种物料的烘干、固化、烘烤等工艺，如食品、电子、化工、涂装等领域。
- ◆空间利用率高：采用隧道式结构，充分利用了空间，占地面积相对较小。
- ◆运行稳定可靠：经过精心设计和制造，设备运行平稳，故障率低，易于维护和保养。



Product features

- ◆ continuous production: to achieve the continuous transmission and heating of materials, greatly improve the production efficiency, suitable for large-scale, batch production.
- ◆ temperature uniformity: through reasonable design of air duct and layout of heating elements, the temperature distribution in the furnace is more uniform to ensure consistent product heating, thus improving the stability of product quality.
- ◆ high degree of automation: it can be used with automatic production line to realize the automatic control of feeding, heating, discharging and so on.
- ◆ different heating modes: common electric heating, gas heating, fuel heating, etc. , according to the actual demand and energy supply situation to choose the appropriate heating mode.
- ◆ Energy-efficient: good insulation can effectively reduce heat loss, improve efficient energy use and reduce production costs.
- ◆ Strong Adaptability: it is suitable for drying, curing and baking of various materials, such as food, electronics, chemical industry, coating and other fields.
- ◆ high utilization rate of space: Tunnel-type structure is adopted, which makes full use of space and covers relatively small area. Stable and reliable operation: After careful design and manufacture, the equipment runs smoothly, low failure rate, easy maintenance and maintenance.



专业设计、制造、销售烘干固化设备并提供全面工程及解决方案

工业箱式固化烤炉

Industrial box type curing oven



产品特点

- ◆温度控制精准：电加热元件能够提供更稳定和精确的温度控制，便于设定和保持特定的烘烤温度，适合对温度要求较高的烘焙或烹饪。
 - ◆清洁方便：没有燃烧产生的废气和残留物，内部相对容易清洁，保持卫生。
 - ◆启动迅速：通电后即可开始加热，无需预热等待时间较短。
 - ◆操作简单：使用起来较为便捷，通常只需调节温度和时间等简单设置。
- 燃气烤箱的优点：
- ◆成本相对较低：如果当地燃气价格较为便宜，使用燃气烤箱的运行成本可能会低于电加热烤箱。
 - ◆加热速度快：能够迅速产生大量的热量，使烤箱内部快速升温。
 - ◆烘焙效果独特：某些食品在燃气烤箱中烘焙可能会形成独特的色泽和口感。
 - ◆不受电力限制：在电力供应不稳定或停电的情况下，仍能正常使用。



Product Features

- ◆temperature control accuracy: electric heating elements can provide more stable and accurate temperature control, easy to set and maintain a specific baking temperature, suitable for the temperature requirements of baking or cooking.
- ◆Clean and convenient: no waste gas and residue from combustion, the interior is relatively easy to clean and keep clean.
- ◆Fast start-up: heating can be started after power-on, no need to preheat the waiting time is short.
- ◆simple operation: it is convenient to use, usually only need to adjust the temperature and time and other simple settings. Advantages of gas ovens:
- ◆costs are relatively low: if local gas prices are cheaper, the operating costs of using gas ovens may be lower than electric heating ovens.
- ◆High heating speed: it can quickly generate a large amount of heat, so that the oven internal rapid warming. Unique baking effect: some foods may form
- ◆unique color and taste when baked in gas oven. 8 not limited by electricity: in the power supply instability or power outage, still can be used normally.



专业设计、制造、销售，高低温烘烤固化设备，并提供全面工程及解决方案

Professional design, manufacturing, sales, high and low temperature baking and curing equipment, and providing comprehensive engineering and solutions



自动化输送设备

Automated conveying equipment

产品特点

- ◆高效性：连续输送，提高生产效率
- ◆准确性：精准输送到指定位置，减少停机时间
- ◆多层输送，根据需求非标定制
- ◆
- ◆使用寿命超平均水平，低维护成本

Product Features

- ◆High Efficiency: continuous transportation, improve the production efficiency accuracy;
- ◆accurate transportation to the designated position, reduce the downtime multi-layer transportation,
- ◆according to the
- ◆demand non-standard design easy installation
- ◆life exceed the average level, low maintenance costs

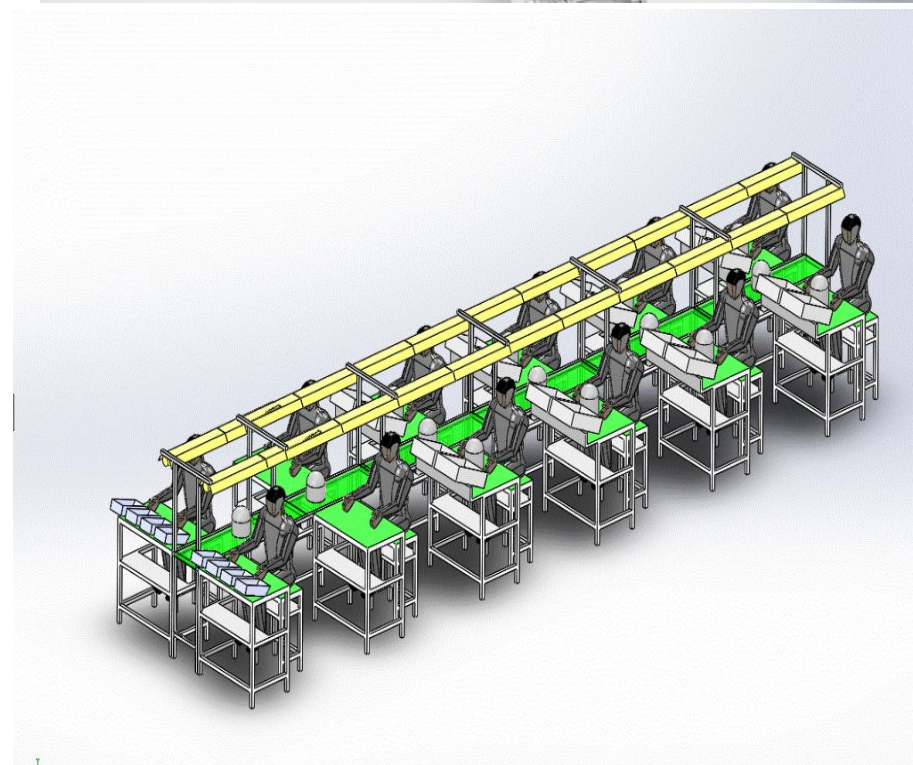

智能输送系统

Intelligent conveying system

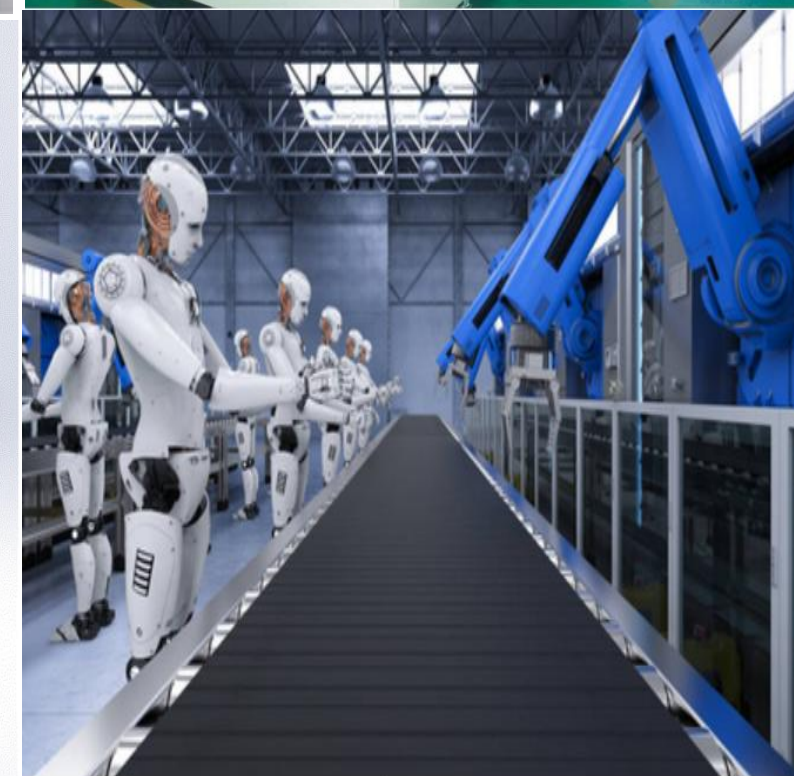

专业设计、制造、销售自动化输送设备并提供全面工程及解决方案
Professional design, manufacturing, and sales of automated conveying equipment, providing comprehensive engineering and solutions



涂装废气处理设备

Painting exhaust gas treatment equipment

产品特点

- ◆连续生产：能够实现物料的连续输送和加热，大大提高了生产效率，适合大规模、批量涂装催化燃烧具有以下特点：
- ◆高效净化：能将有机废气中的有害物质转化为无害物质，净化效率高，通常可达 90%以上，有效减少对环境的污染。
- ◆节能降耗：起燃温度相对较低，在较低的温度下就能实现有机废气的氧化反应，从而降低了能源消耗。
- ◆适用范围广：可处理多种类型的有机废气，包括挥发性有机物（VOCs）、苯系物、醇类、酮类等，适用于涂装等众多行业。
- ◆稳定性好：催化剂具有较好的稳定性和耐久性，在一定使用期限内能够保持较高的活性和性能。
- ◆无二次污染：燃烧产物主要为二氧化碳和水，不会产生新的污染物。
- ◆操作简便：系统自动化程度较高，操作相对简单，易于控制和维护。
- ◆占用空间小：设备结构紧凑，占地面积相对较小，便于在工厂内安装和布局。
- ◆安全可靠：配备了完善的安全保护装置和监控系统，确保运行过程中的安全性。



Product Features

- ◆Continuous Production: it can realize the continuous transportation and heating of materials, and greatly improve the production efficiency. It is suitable for large-scale and batch catalytic combustion of coating with the following characteristics:
- ◆High efficiency purification: it can transform the harmful substances in the organic waste gas into harmless substances with high purification efficiency, usually up to 90% , effectively reducing the pollution to the environment.
- ◆Energy saving: the ignition temperature is relatively low, in the lower temperature can achieve the oxidation of organic waste gas, thus reducing energy consumption.
- ◆Wide range of applications: it can handle various types of organic waste gases, including Volatile organic compound (VOCs) , benzene series, alcohols, ketones, etc. .
- ◆Good Stability: the catalyst has good stability and durability, in a certain period of time to maintain high activity and performance.
- ◆No secondary pollution: combustion products mainly for carbon dioxide and water, will not produce new pollutants.
- ◆Easy to operate: the system is highly automated, relatively simple to operate, easy to control and maintain.
- ◆Small footprint: compact structure, relatively small footprint, easy to install and layout in the factory.
- ◆Safe and reliable: equipped with a comprehensive security protection device and monitoring system to ensure the safety of the operation process.

空气质量直接关系到我们的健康和生活质量。绿植不仅可以吸收有害物质，释放氧气，还能调节室内湿度，改善空气质量。让绿植成为你家的空气净化器，让每一次呼吸都充满清新与宁静。

Air quality is directly related to our health and quality of life. Green plants can not only absorb harmful substances and release oxygen, but also regulate indoor humidity and improve air quality. Make green plants your home's air purifier, filling every breath with freshness and tranquility.

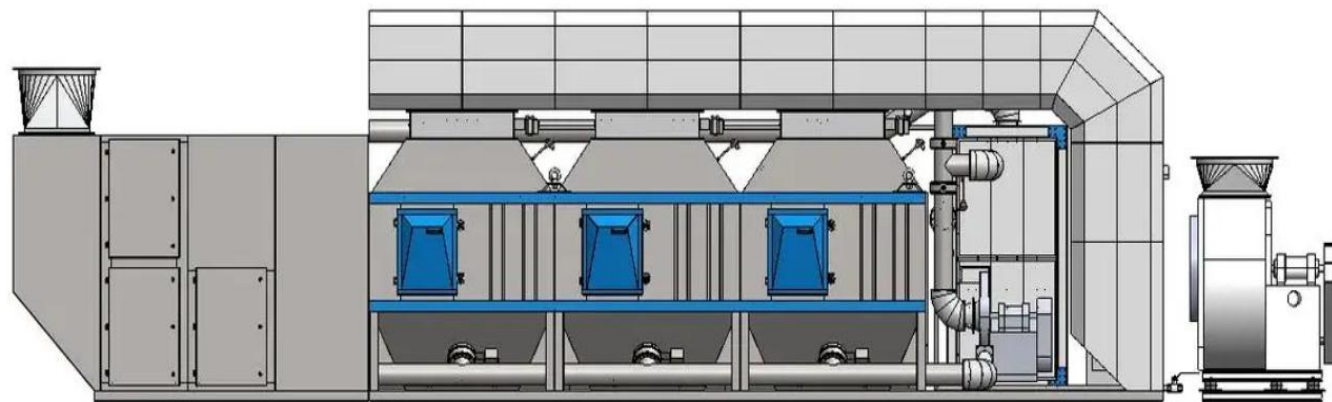

专业设计、制造、销售涂装废气处理设备并提供全面工程及解决方案

Professional design, manufacturing, and sales of painting exhaust gas treatment equipment, and providing comprehensive engineering and solutions



工程案例

Project case

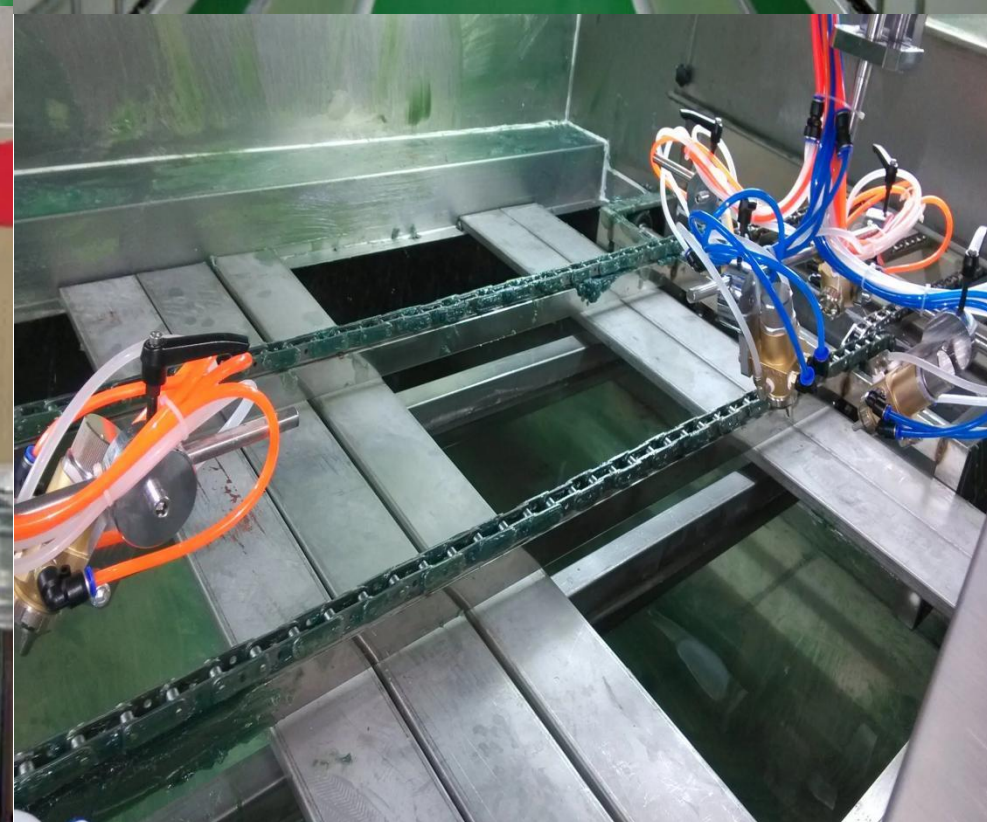



供应伙伴Supply Partner



ABB



SATA

DEVILBISS

アネスト岩田株式会社
ANEST IWATA

CNP 南方泵业

YASKAWA

Durkee Sox® | 杜肯索斯®
全球纤维织物风管系统领导品牌

上海通用风机股份有限公司
SHANGHAI GENERAL FAN CO.,LTD



DEMAG

**合作伙伴
cooperation
Partner**

CTI
Member of
Paul Wurth
Group
SYSTEMS

SIEMENS



我们以资源共享、技术共享、利益共享为合作理念，长久合作、共同进步、共赢发展。

We take resource sharing, technology sharing and benefit sharing as the cooperation idea, long-term cooperation, common progress and Win-win Development.